

Sustainable Social Institutions

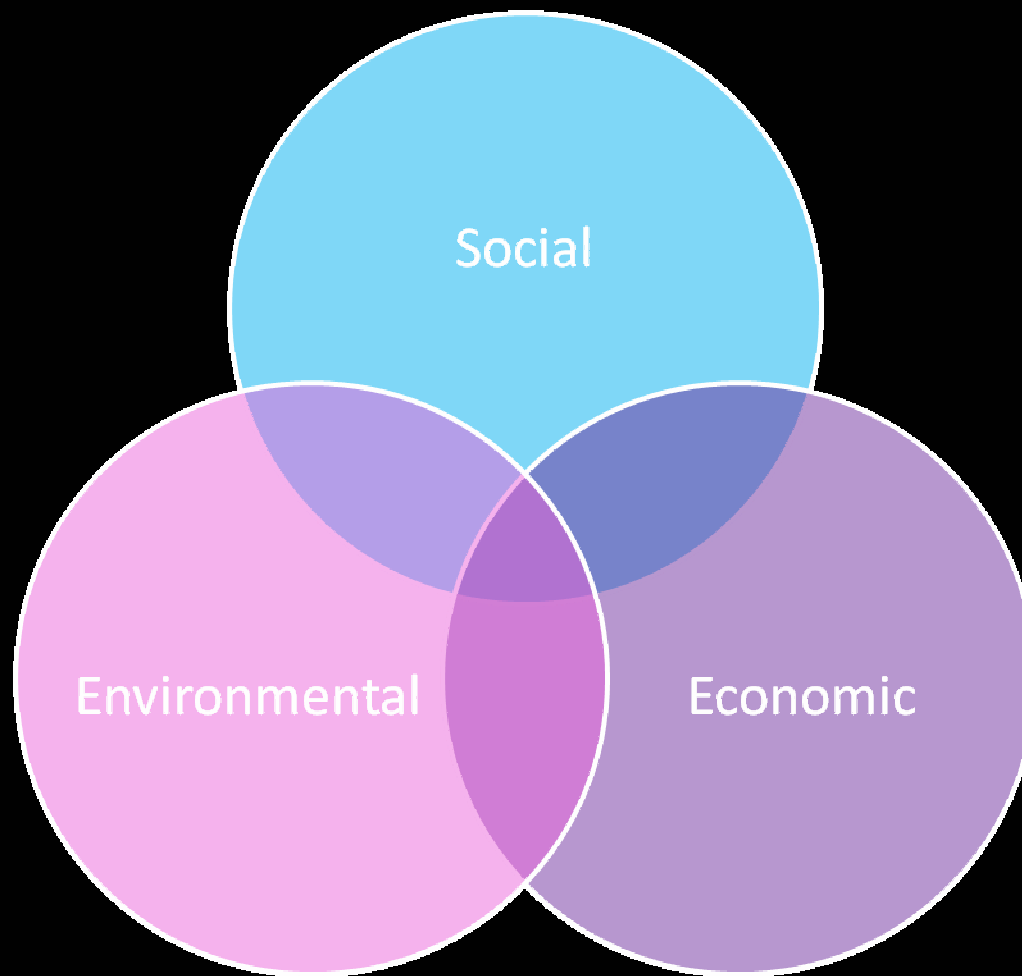

**THE THREE
SUSTAINABILITIES**



CASE STUDY 1 – THE UNIVERSITY OF CYPRUS

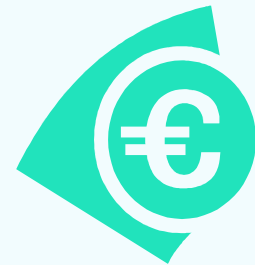

THE DIVIDED ISLAND

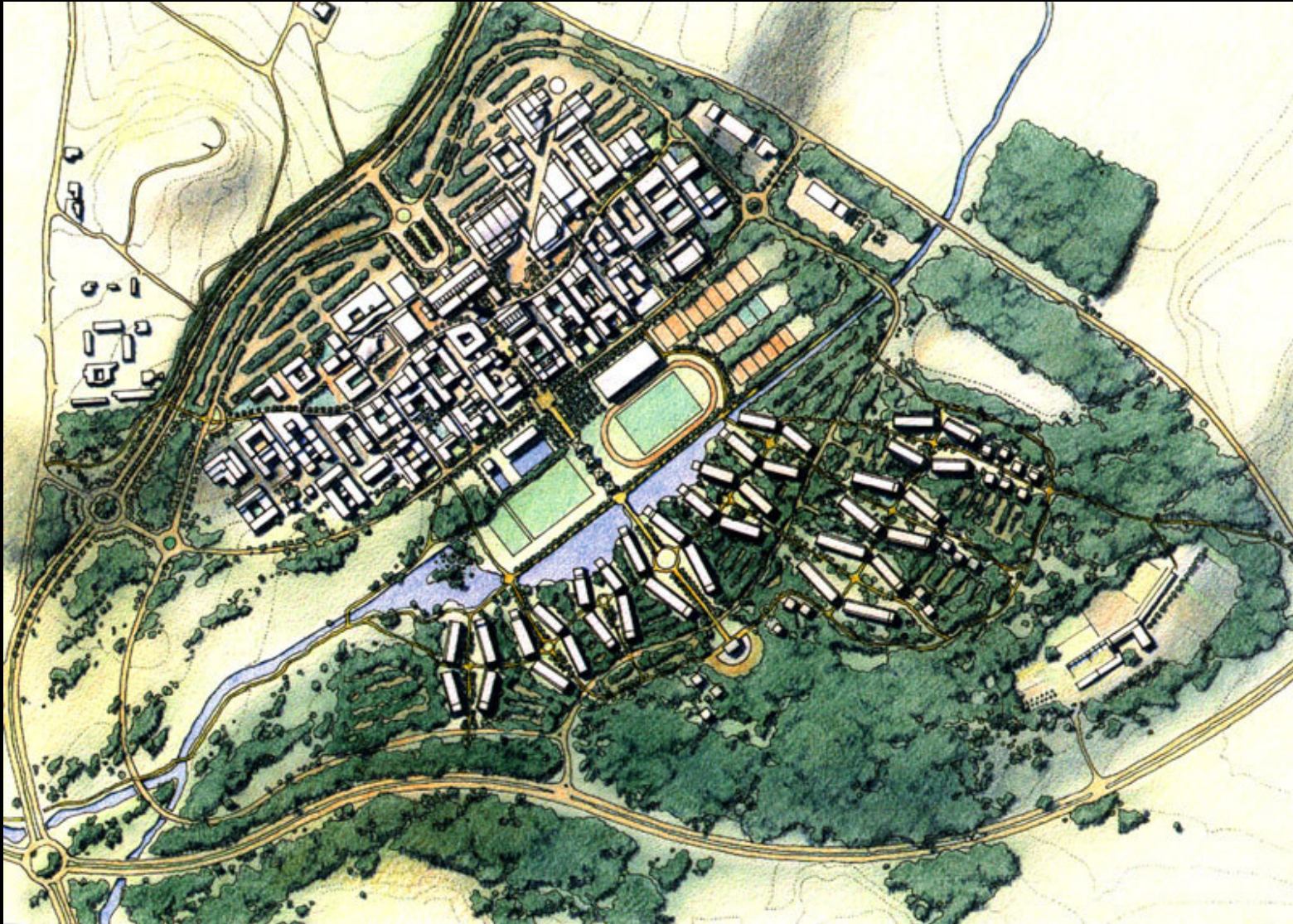

THE 1994 MASTERPLAN

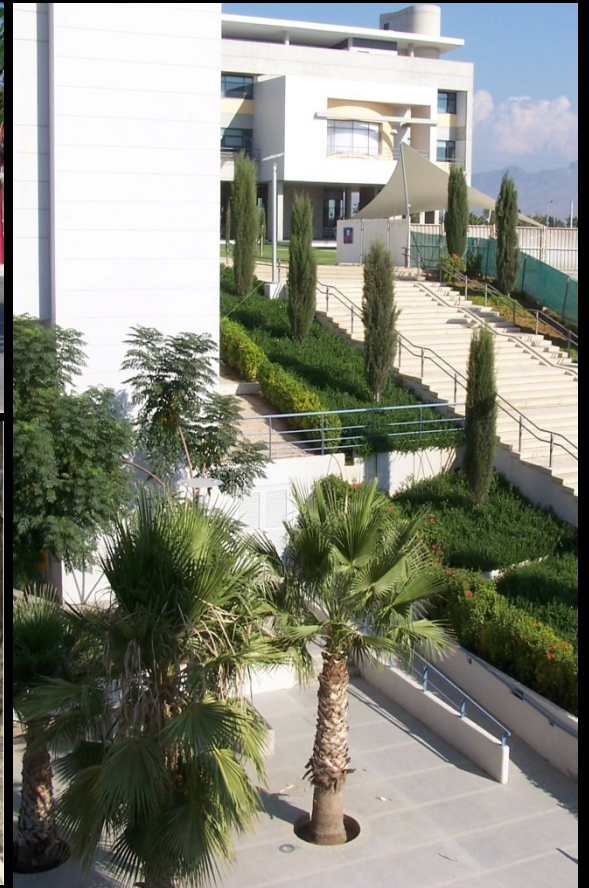

THE INFRASTRUCTURE



THE BUILDINGS



EXTENDING THE NATIONAL PARK



THE NATIONAL PARK EXTENSION

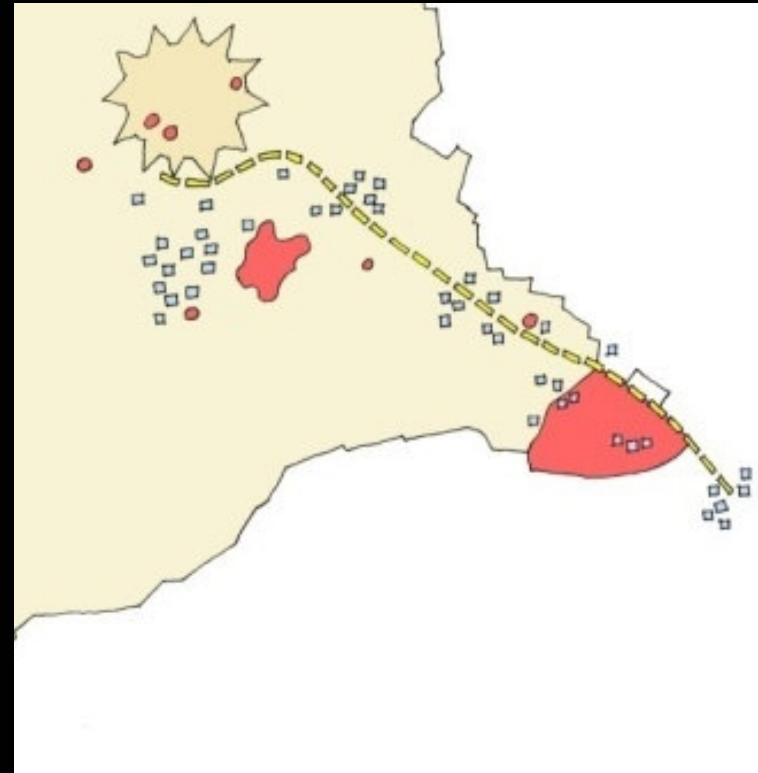
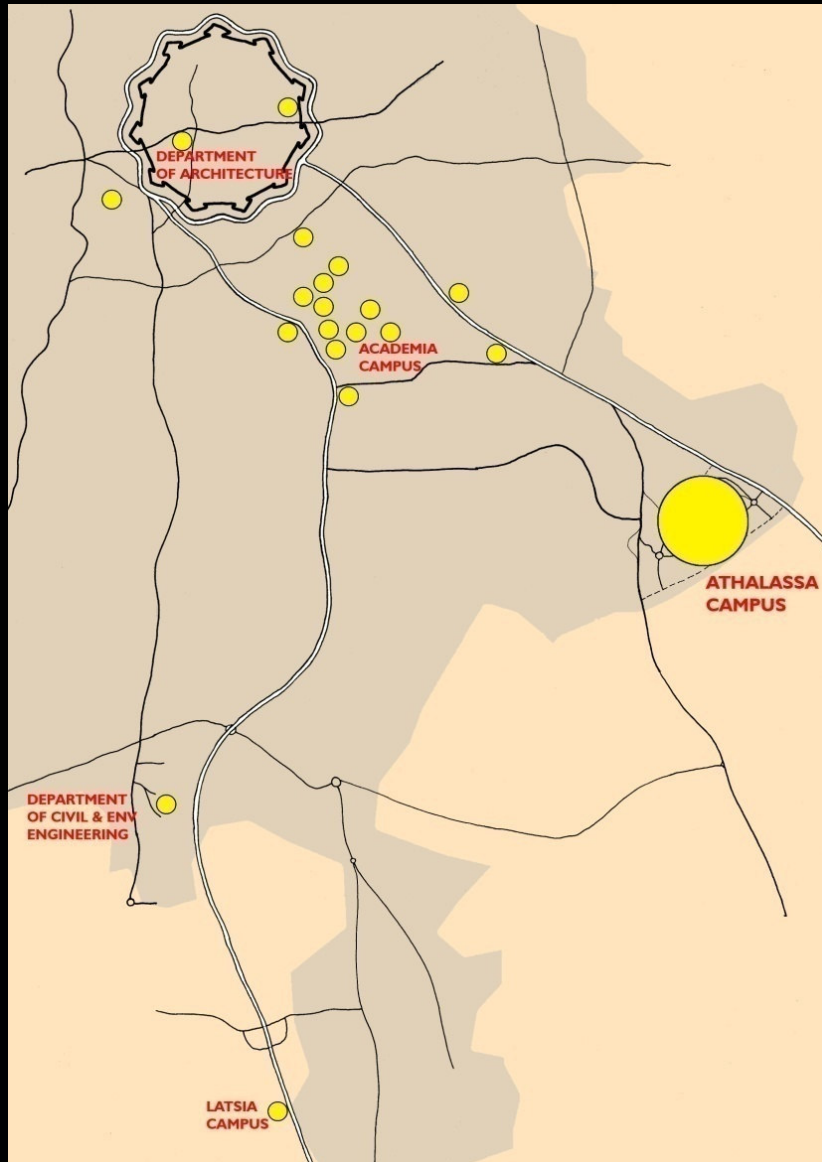

THE CURRENT CONTEXT

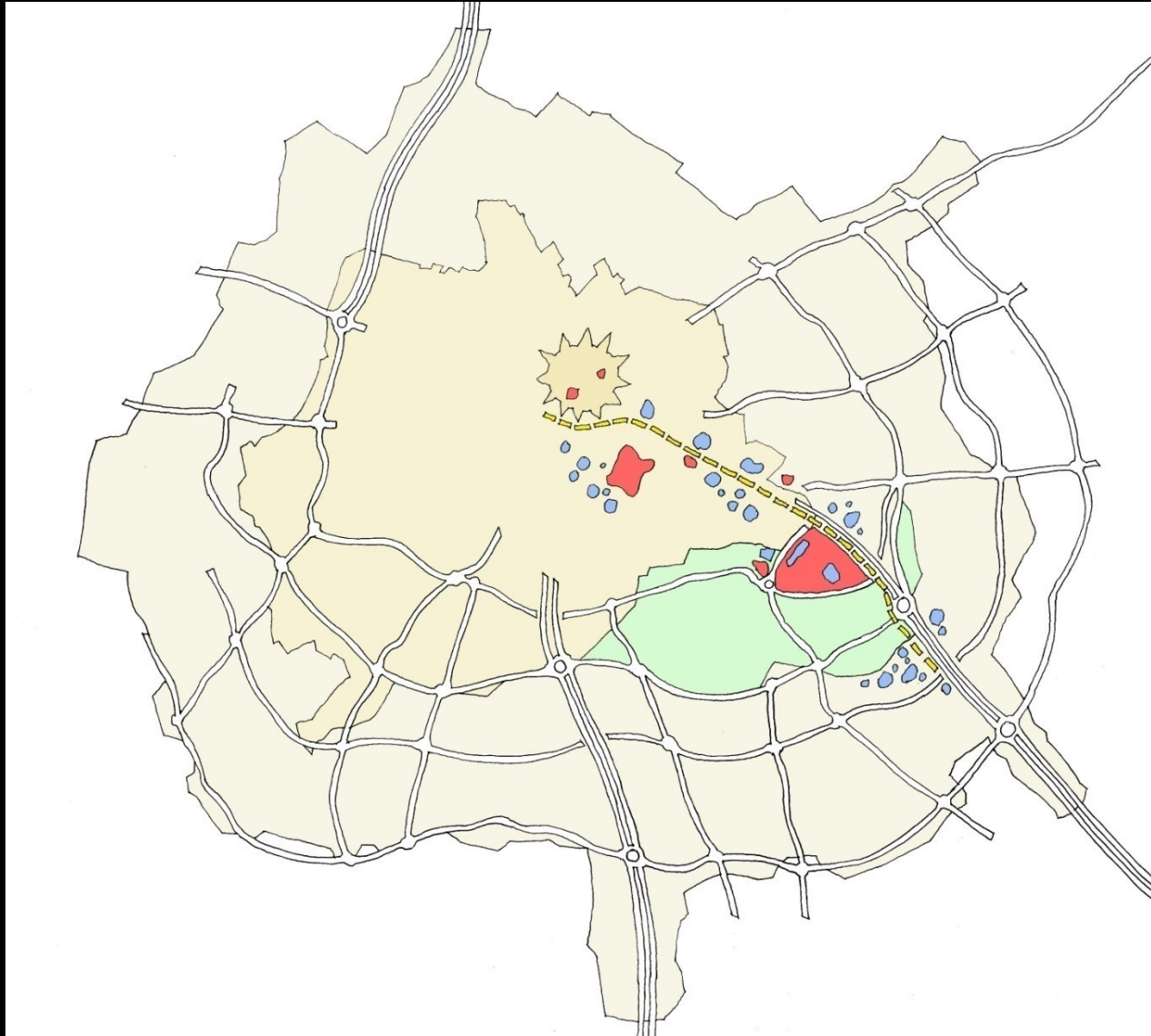

THE UNIFIED CONTEXT

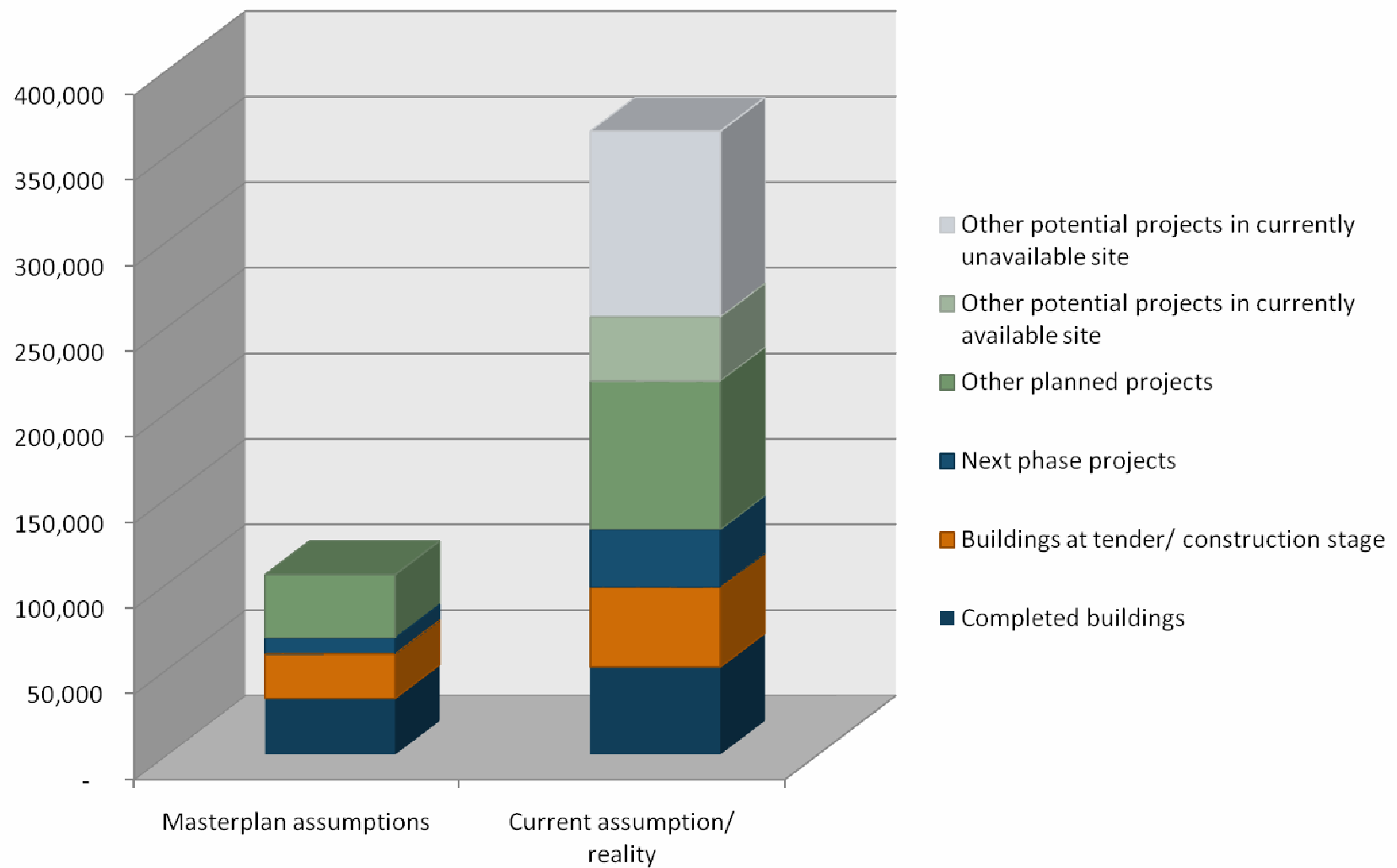

THE CARROTS

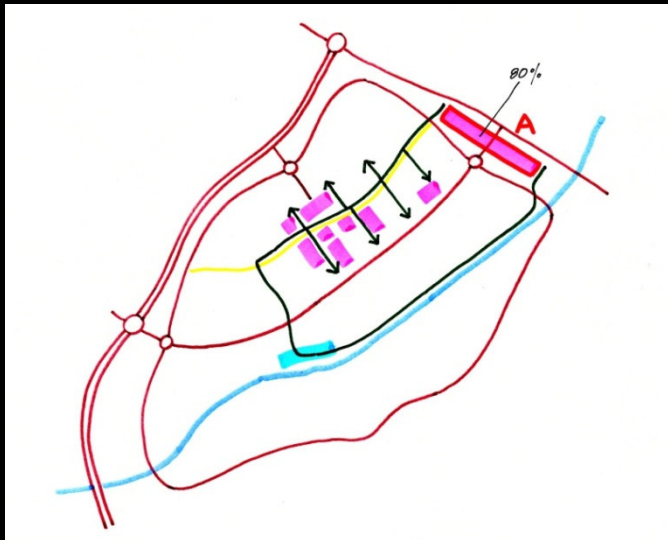

EXISTING

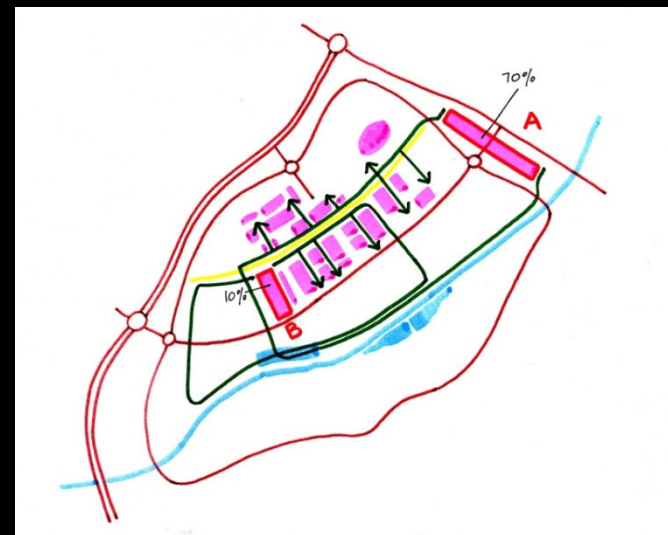

NEXT PHASE



TO CURRENT PLANNED CAPACITY

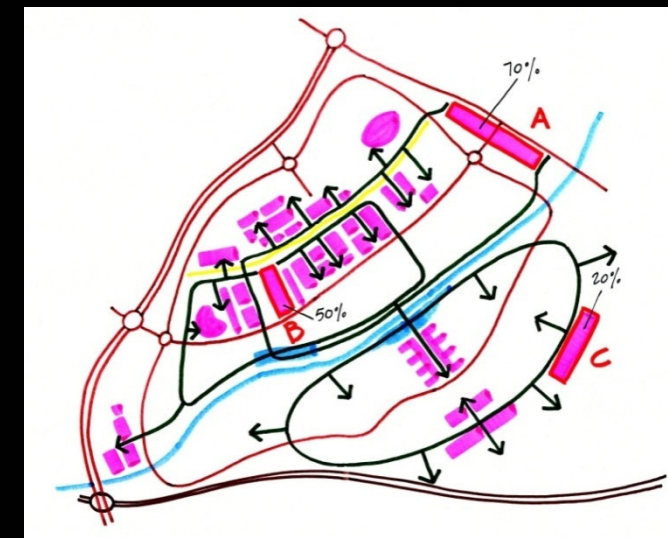

FUTURE PHASE

DIVERSITY OF LOAD AND SUPPLY



THE NEW SITE CAPACITY

	SUCCESS?	ACHIEVEMENT
ENVIRONMENTAL	✓	Design strategies proved robust Can respond to changed context Can incorporate new technologies Raised awareness of occupants
SOCIAL	✓	National objectives delivered Development strategy builds skills Free access to all social groups
ECONOMIC	?	Reduced talent and cash outflows Financed through taxation Growing revenue bill

PERFORMANCE ?

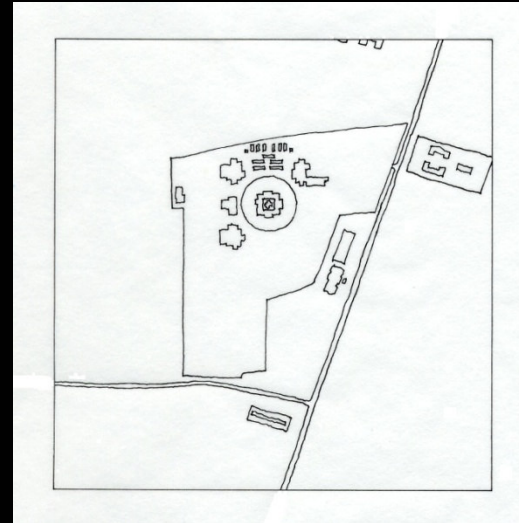

ISB HYDERABAD – THE CHANGING CONTEXT

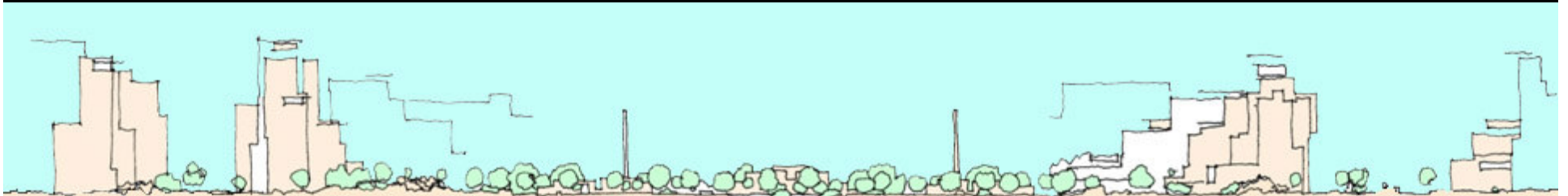
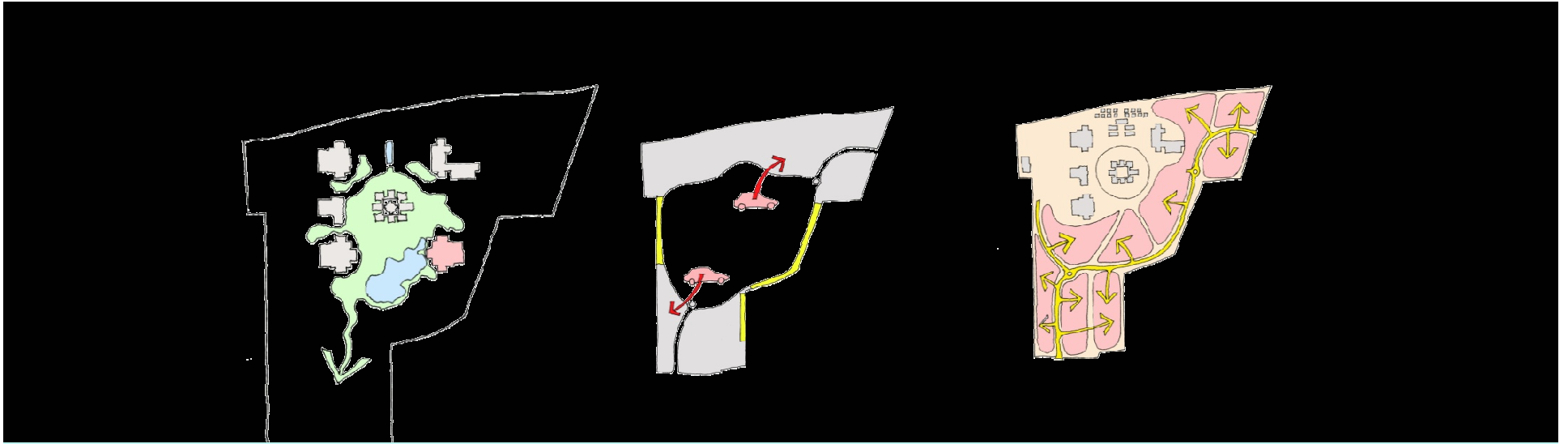

PROTECTING THE ENVIRONMENT

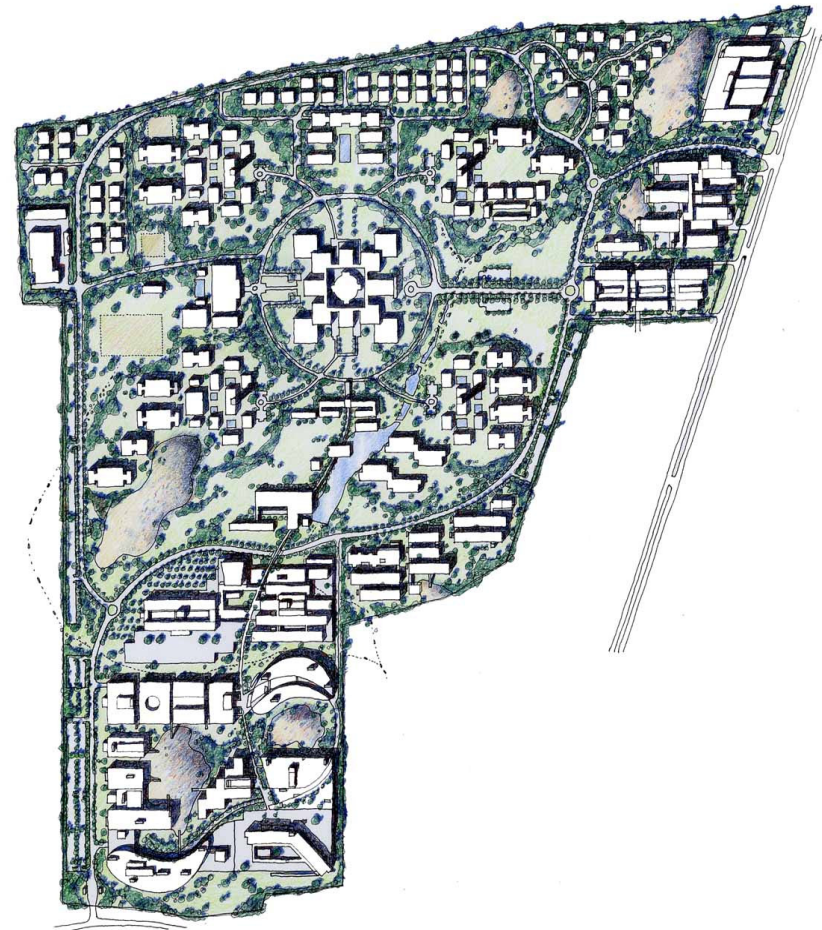
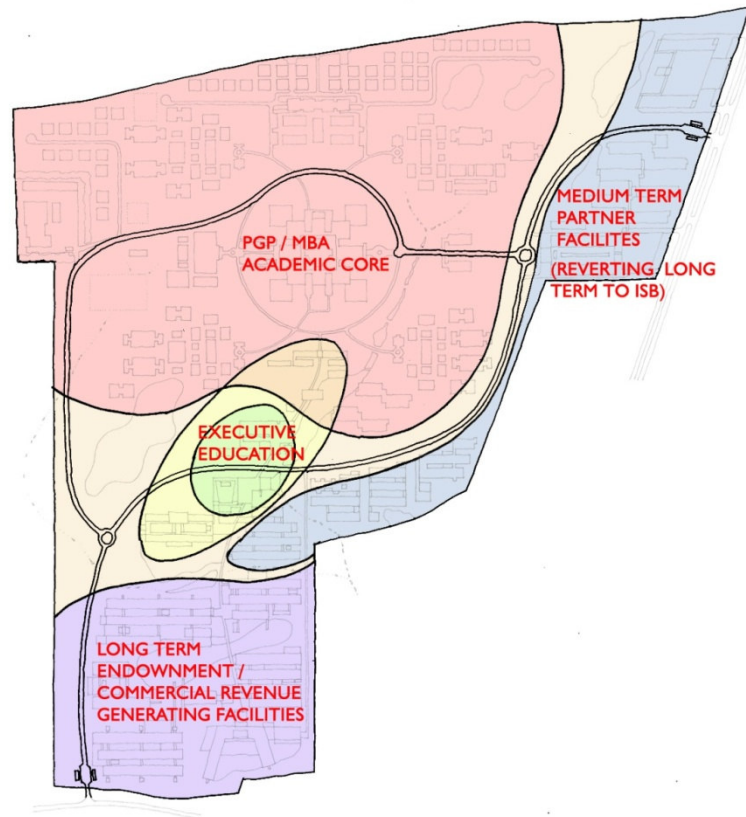

THE FUTURE ENDOWMENT



DEALUL LOMB : CLUJ-NAPOCA : ROMANIA

Cluj - population 400,000
Dealul Lomb - population 30,000
University in centre

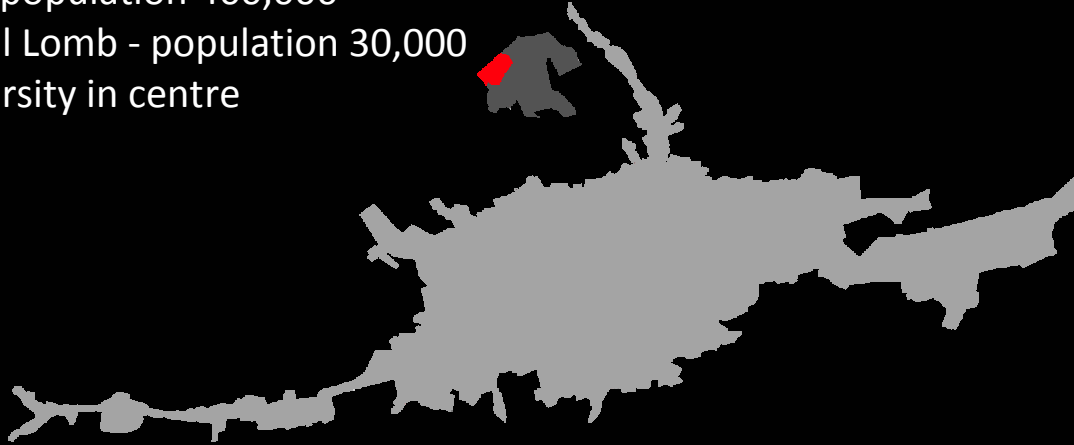

Bristol - population 350,000
Clifton - population 32,000
University in centre

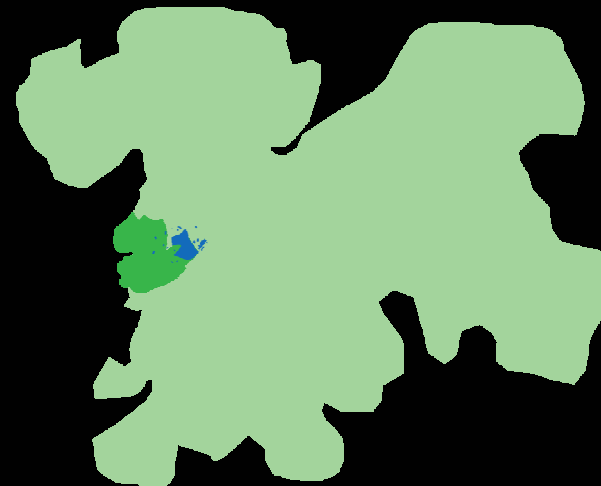

BENCHMARK 1 – CLIFTON BRISTOL



BENCHMARK 2 – HARVARD IN CAMBRIDGE MASS.



THE FULL DEVELOPMENT



THE UNIVERSITY QUARTER

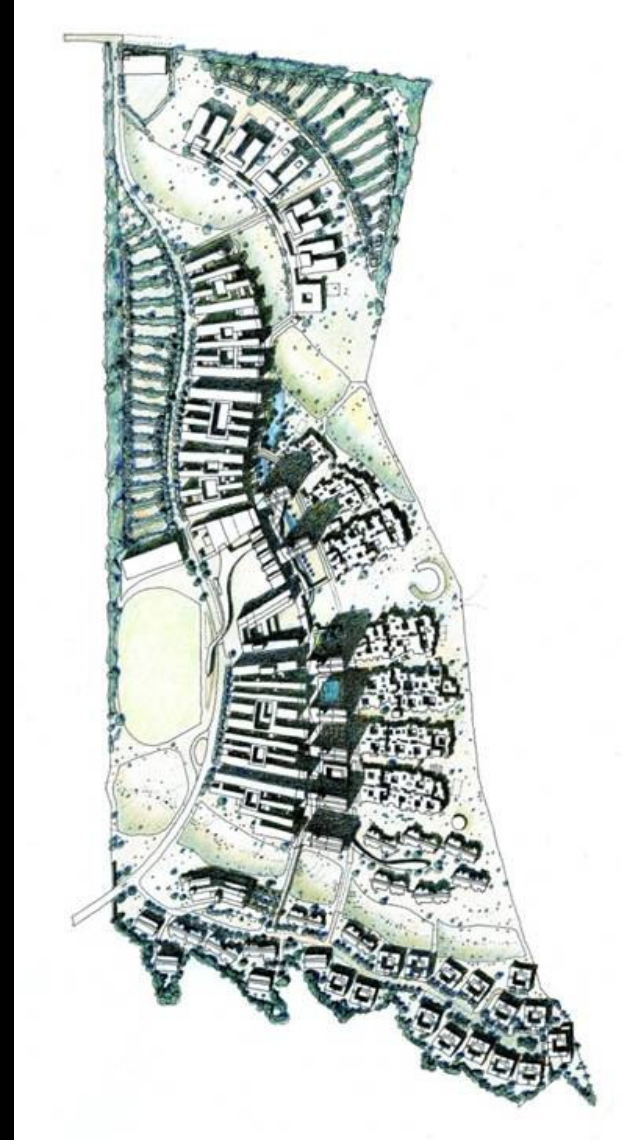

NIIT UNIVERSITY : NEEMRANA: RAJASTHAN

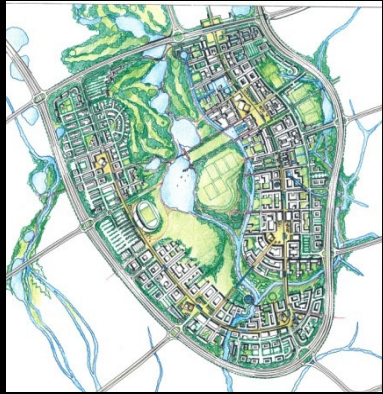

UNIVERSITY OF THE COMMONWEALTH : MALAYSIA

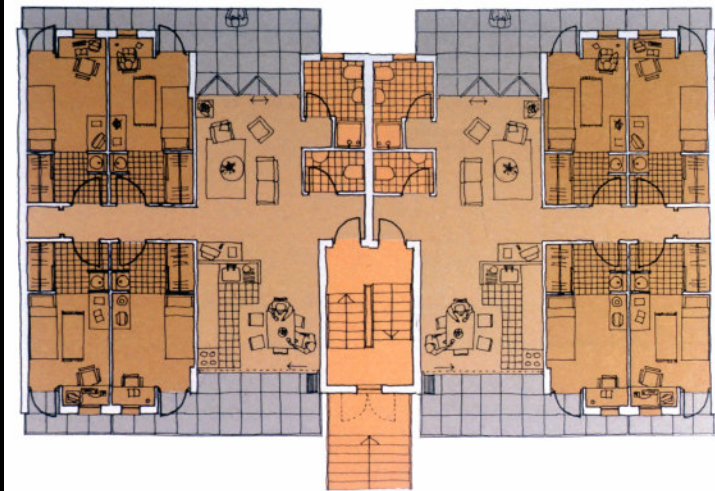

UNIVERSITY OF THE COMMONWEALTH : MALAYSIA



CASE STUDY 2 – BAOBAB MATERNITY HOSPITAL : TANZANIA

Number of Doctors	Per 1000 population	Total
UK	2.9	243,000
India	0.6	670,000
Tanzania	0.04	500

Maternal mortality (/100,000 births)	2005	2009
UK	13	12
India	280	230
Tanzania	860	790

THE BIGGEST PROBLEM OF ALL

Date	Population
1910	36,000
1950	250,000
1975	750,000
2000	2,600,000
2010	4,000,000
2015	5,500,000+



DAR ES SALAAM GROWTH

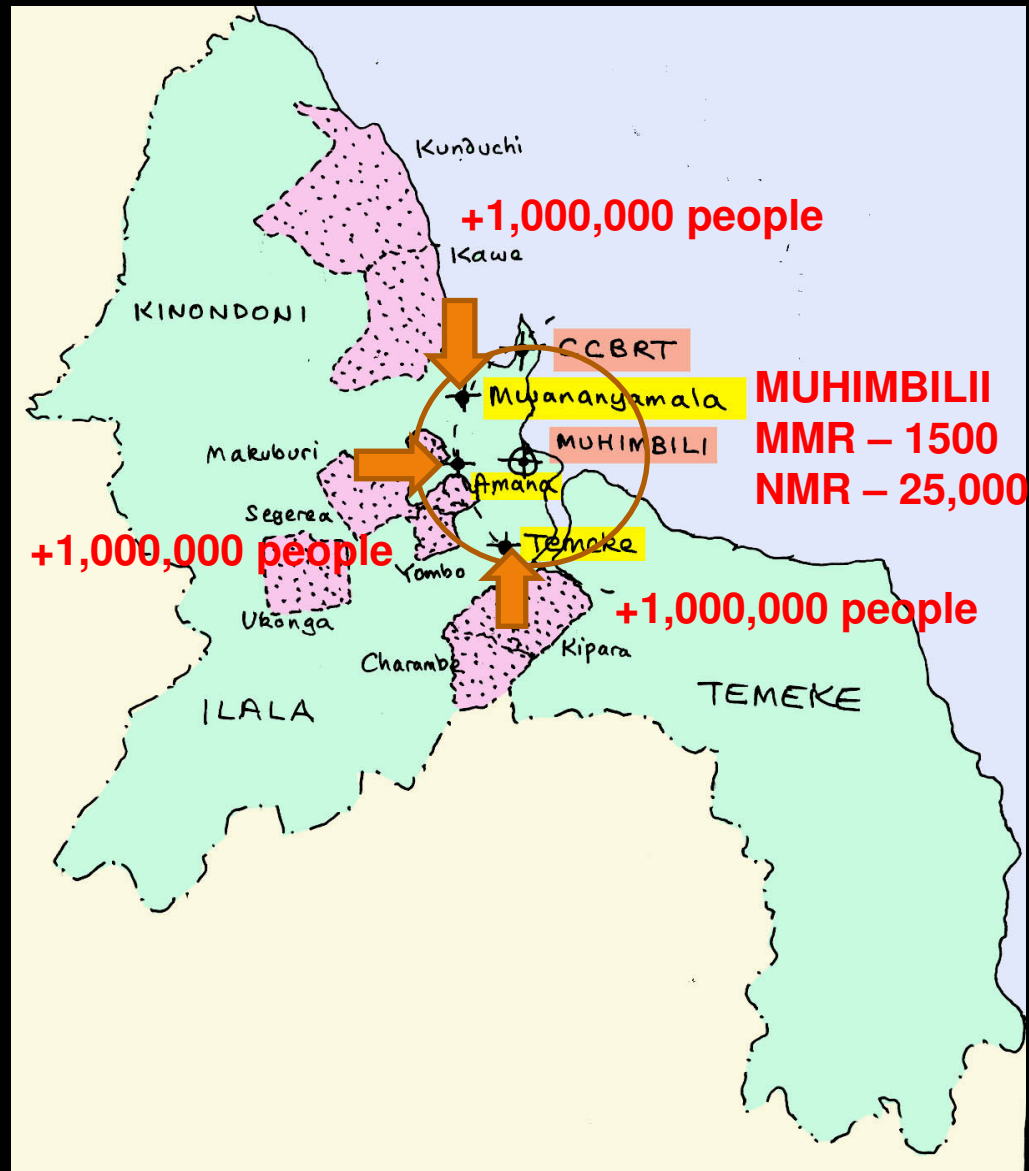

THE CONSEQUENCES OF GROWTH



Trusted partner with the GOT since inception

Addressing priority health gaps; disability, fistula, health education

Strong existing partnerships & culture

Pro poor services 15yrs

Services aligned to national guidelines

Community impact

Strong management

Transparency/ accountability

WHY CCBRT AS THE PPP PARTNER

DESIGN & CONSTRUCTION PHASE

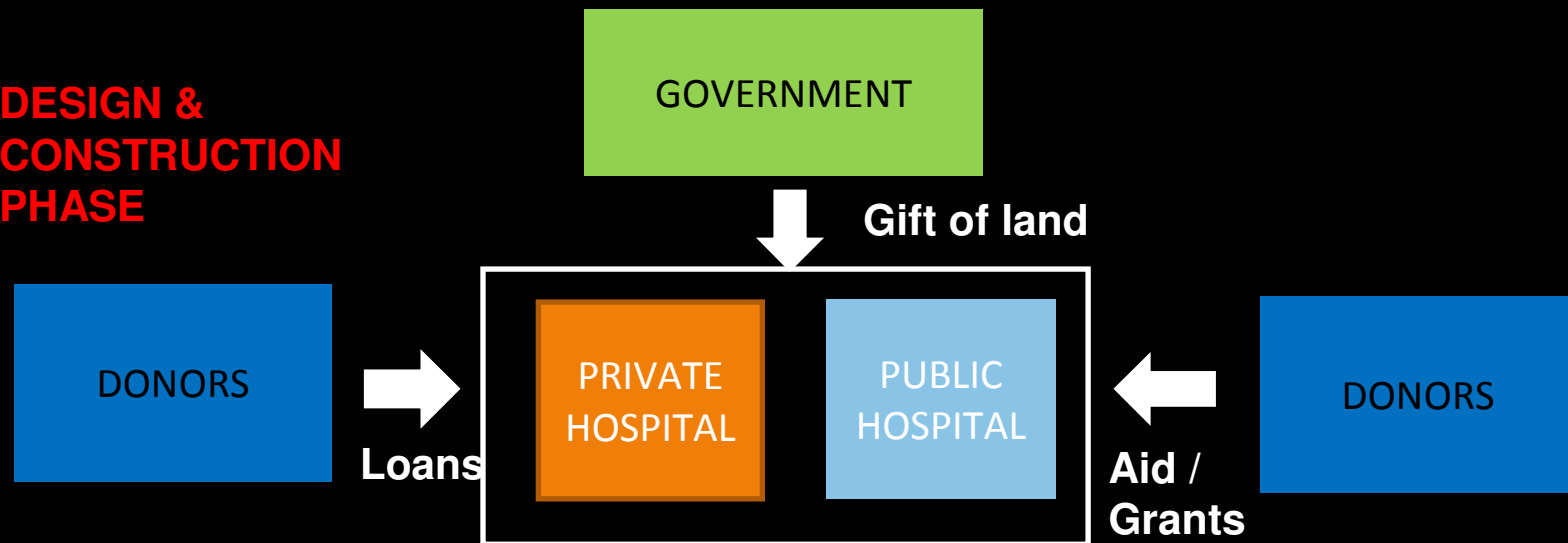

OPERATIONAL PHASE

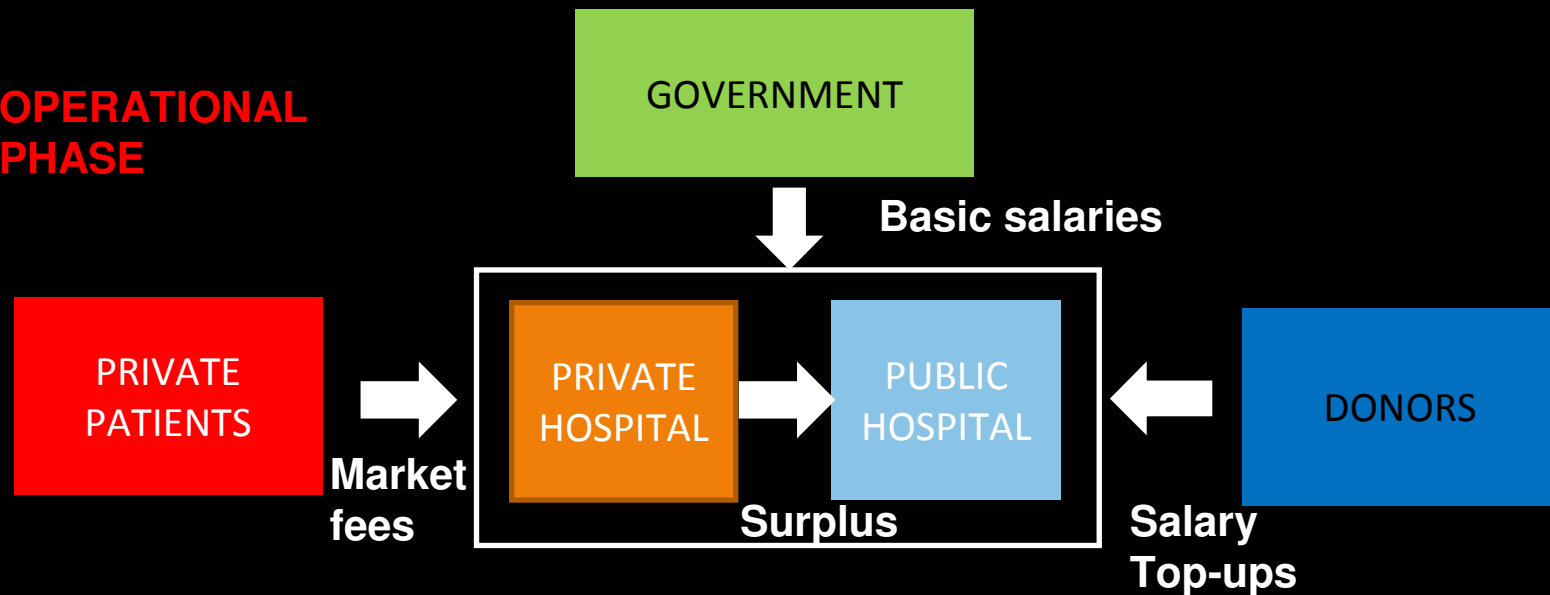

THE "ROBIN HOOD" PRINCIPLE

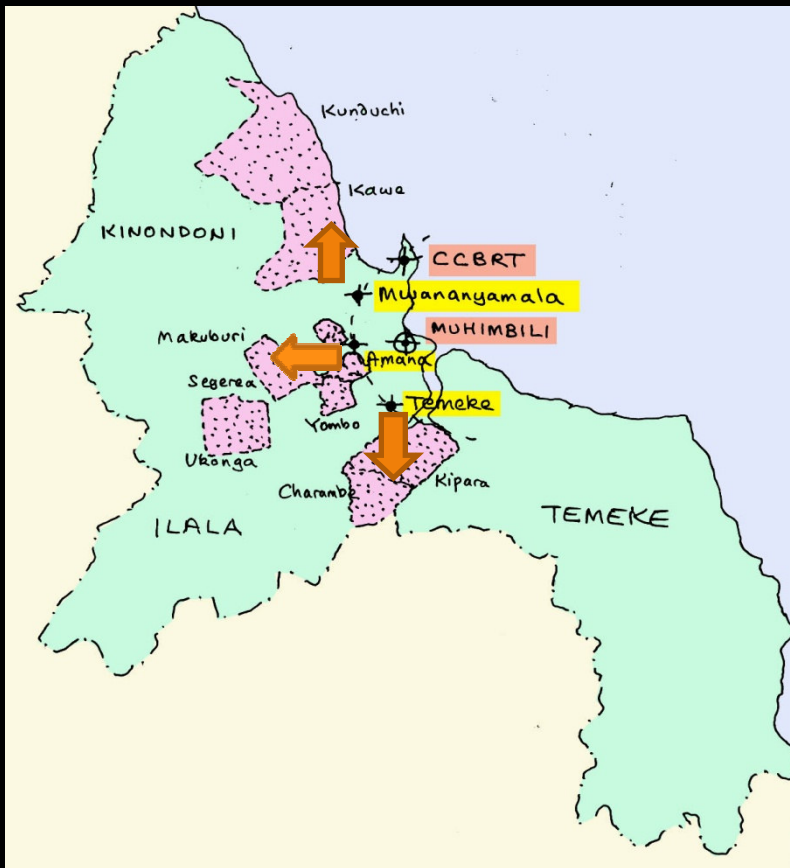

CCBRT upgrade health centres and municipal hospitals (including IT links)

CCBRT provide emergency obstetric care training

CCBRT provide triage service for high risk cases

CCBRT sets up ambulance service between centres

Government provides land and donors fund capital for “hub” centre of excellence

THE LOGISTICS OF A NETWORKED SOLUTION

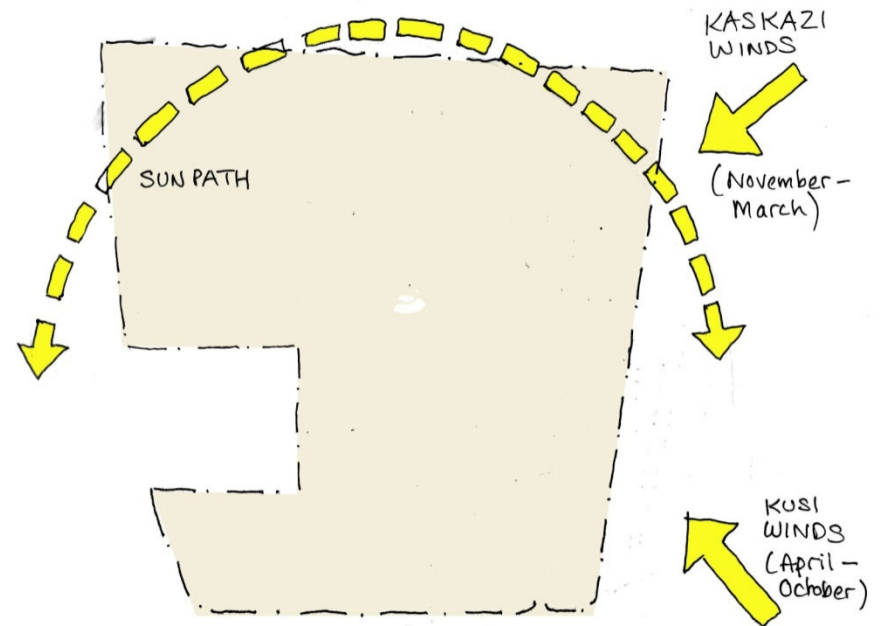
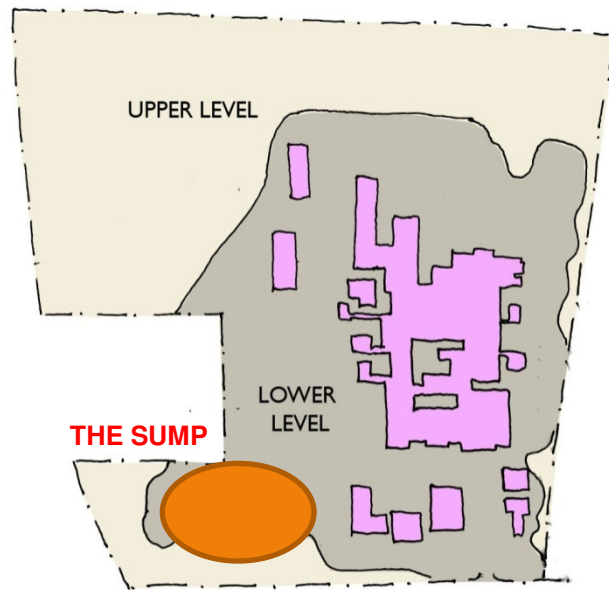

BAOBAB MATERNITY HOSPITAL

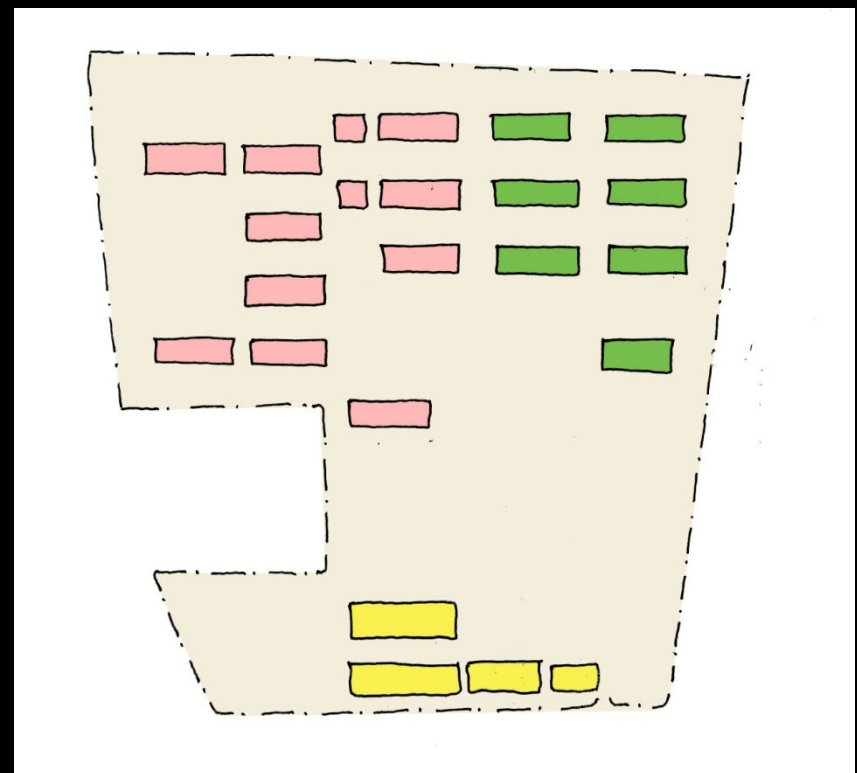
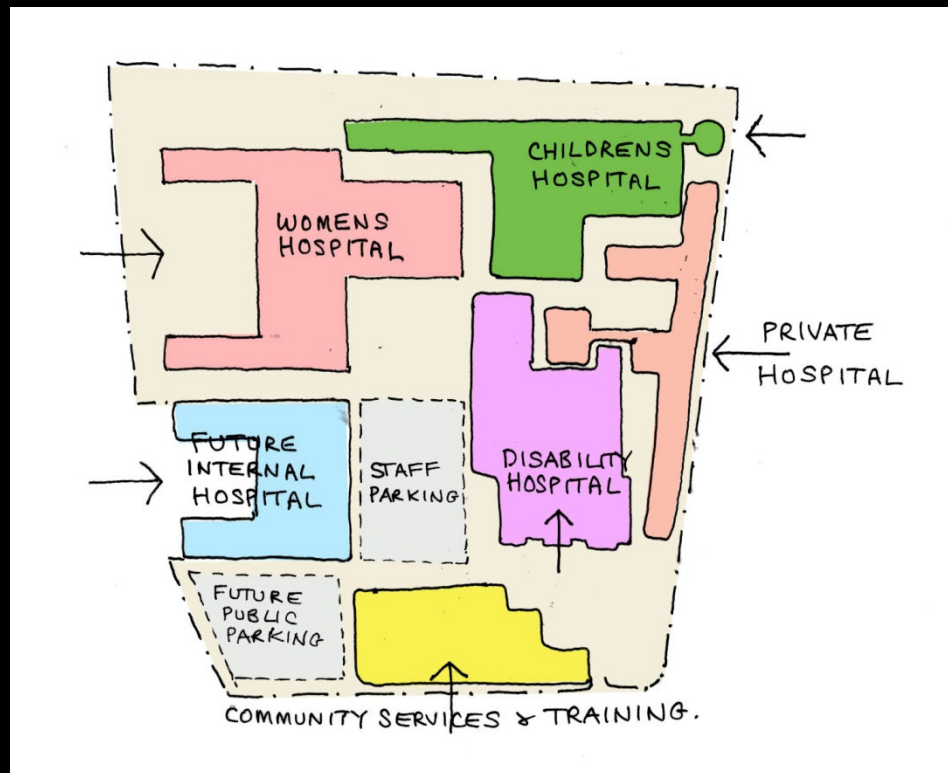

BAOBAB MATERNITY HOSPITAL

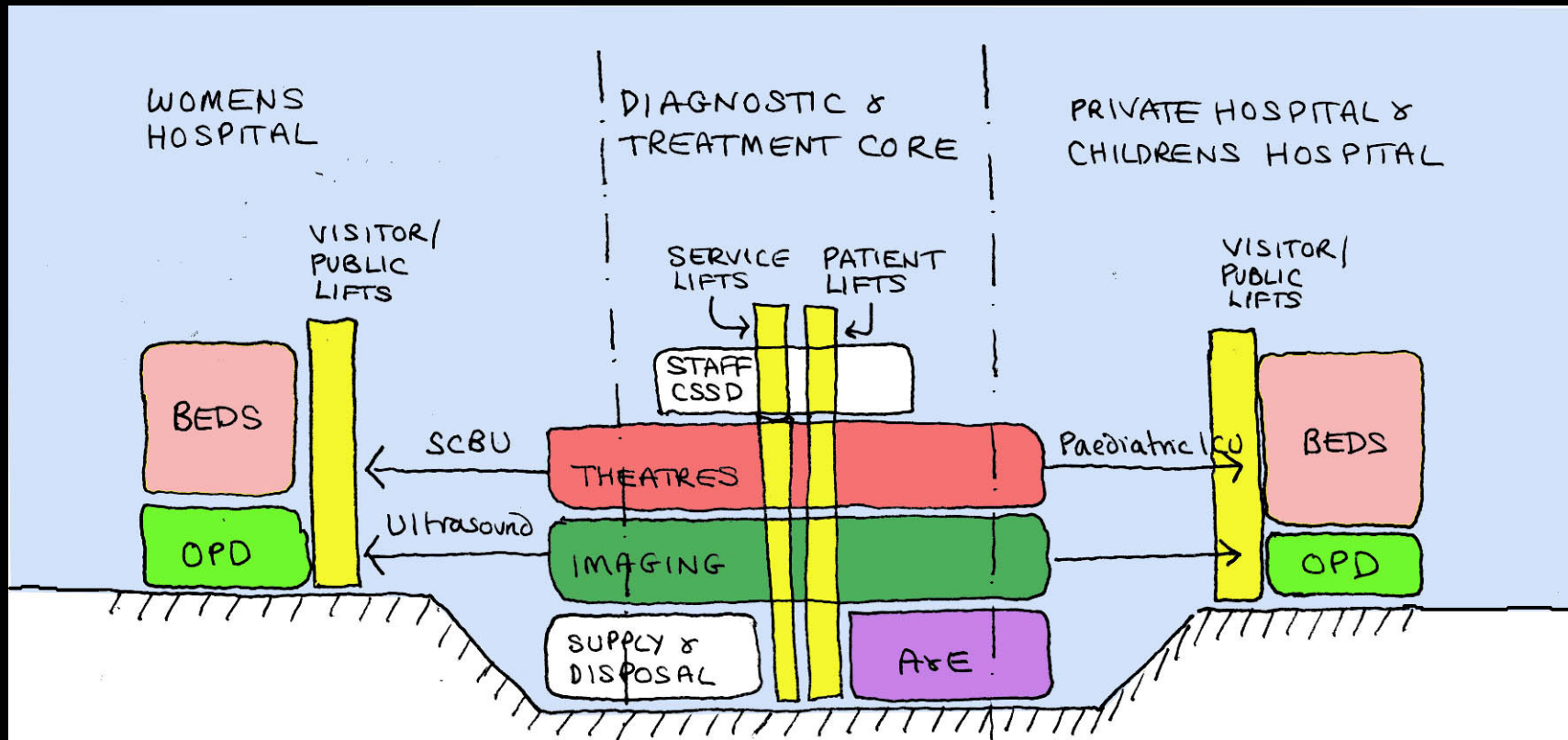

BAOBAB MATERNITY HOSPITAL

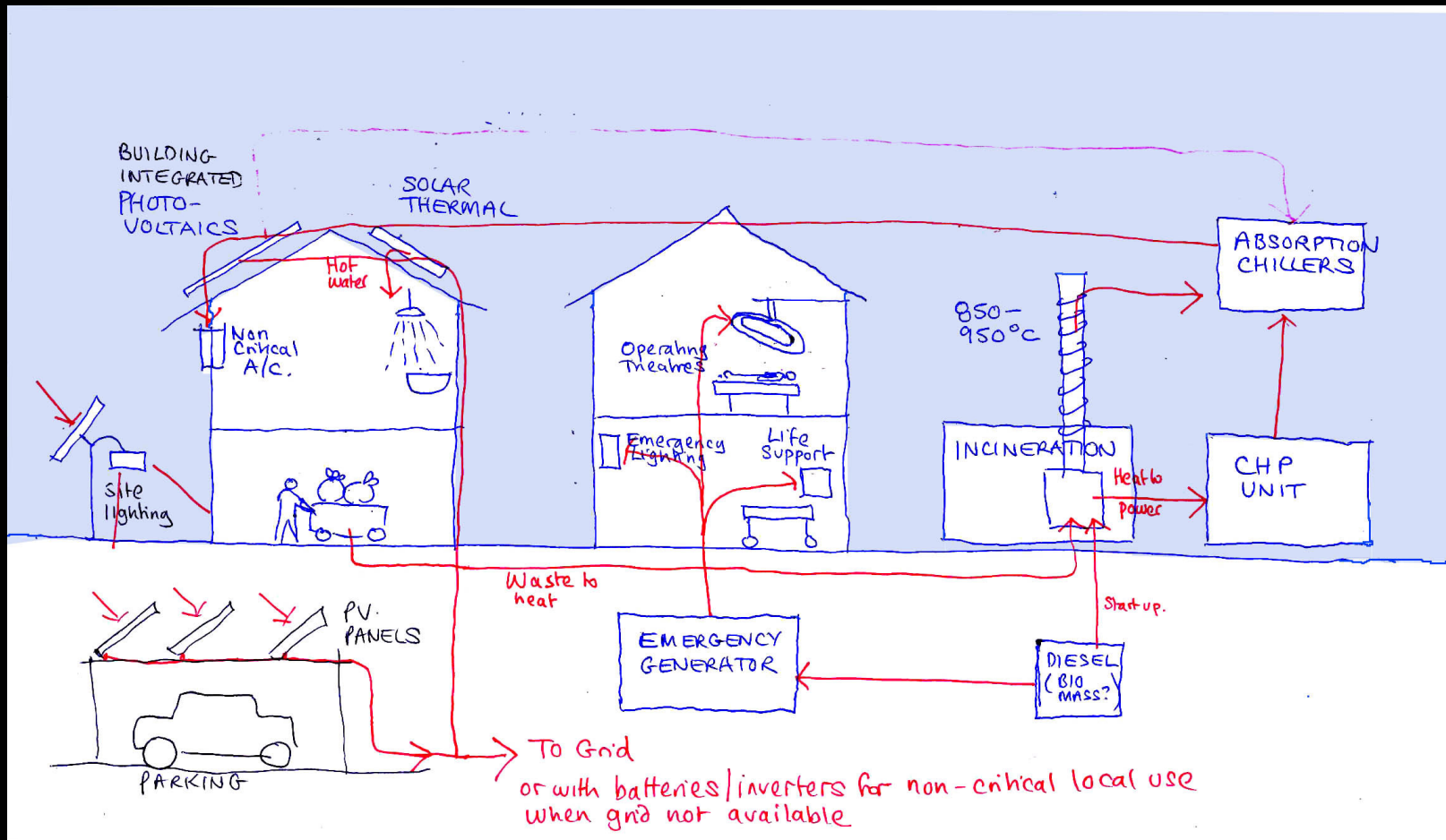

ENERGY STRATEGY



Power Supply

Utility Non-Critical All systems	Generator (Diesel/Solar) Essential Lights/Theatre Equipment/Life Support Services/Water Pumps/ICT/Air Conditioners	Inverter/Batteries Missional Critical Load LoadTheatre Lighting/Life Support/ICT systems.
---	---	---

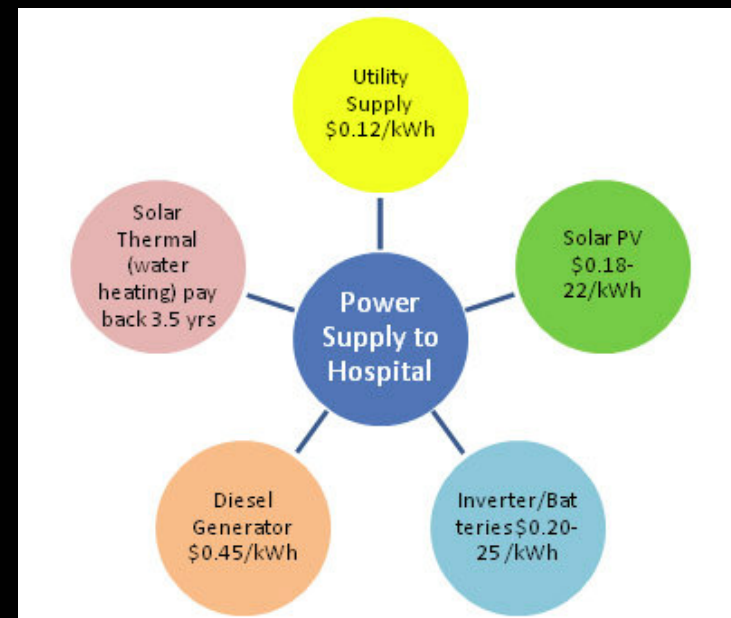

CURRENT CONSTRAINTS & OPPORTUNITIES

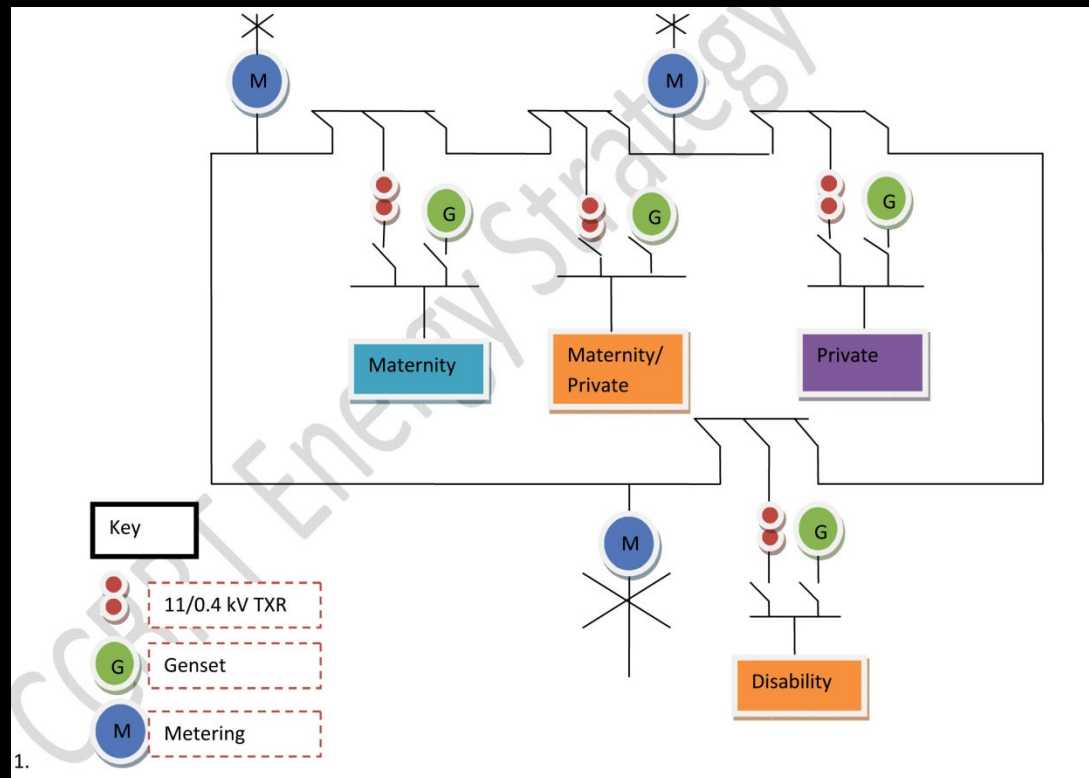

SAFEGUARDED FOR THE FUTURE

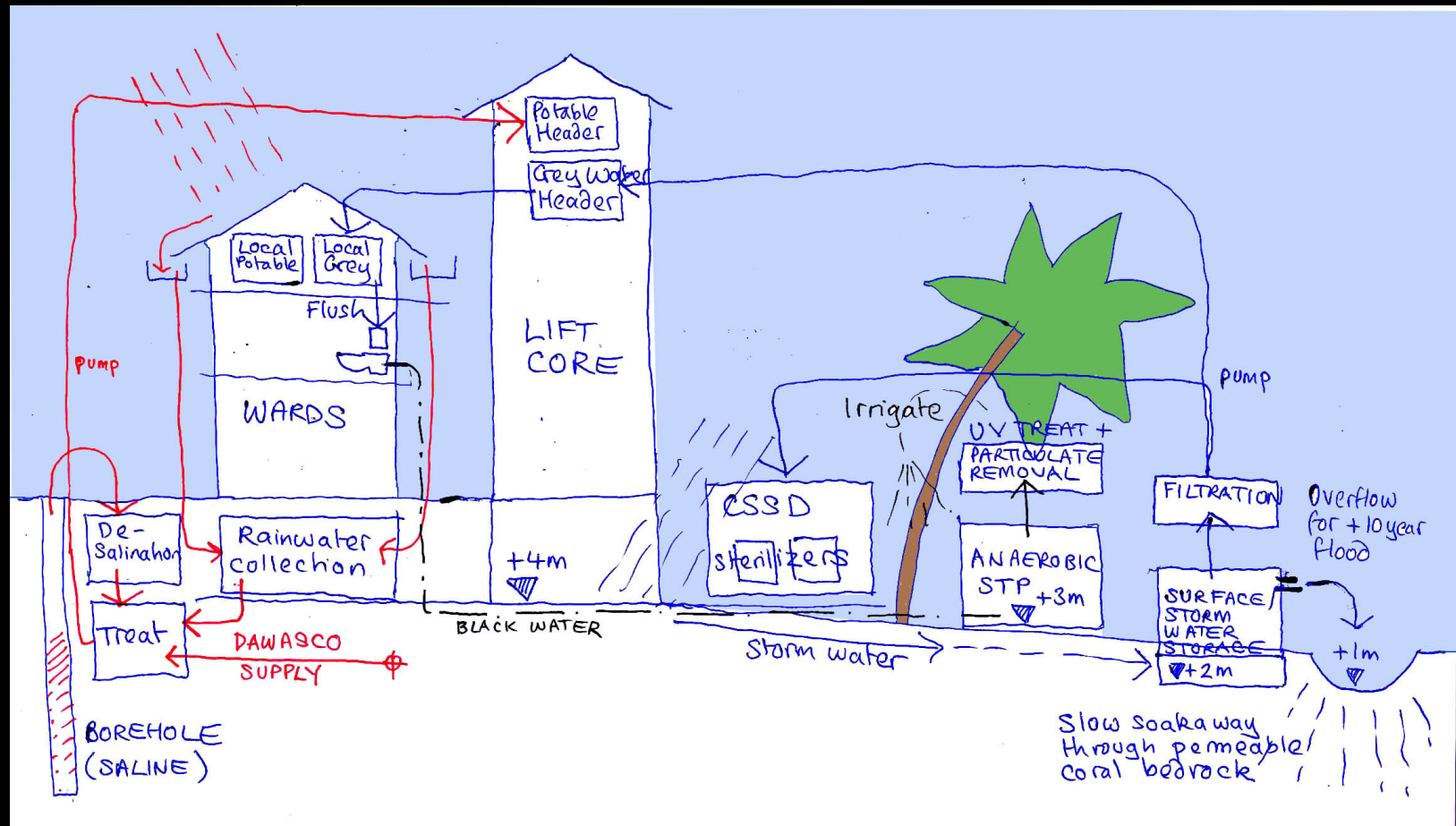

WATER STRATEGY - CONCEPT





BAOBAB MATERNITY HOSPITAL



BAOBAB MATERNITY HOSPITAL

	SUCCESS?	ACHIEVEMENTS
ENVIRONMENTAL	✓	<p>Network strategy v. environmental</p> <p>Design optimises use of scarcest skills</p> <p>Flexible incremental energy strategy</p> <p>Water strategy has urban dimension</p>
SOCIAL	✓	<p>High quality care for all</p> <p>Charges related to means to pay</p> <p>High volume inexpensive care</p> <p>Training & education grow skills</p>
ECONOMIC	✓	<p>Market fees for market service</p> <p>Growing middle class aspiration</p> <p>Expanding income self-generation</p>

PERFORMANCE ?

- Social institutions must support equity and access
- The most important scarce resource is skilled people
- Market mechanisms support the sustainability agenda
- The politics of water and energy self-sufficiency are problematic
- Obsolescence and funding are obstacles to social campus environmental re
- Passive solutions, systemic focus and safeguarding are paramount
- Environmental learning campuses are their own pedagogy
- Design training is not currently meeting social need

REFLECTIONS